

Storage Equipment

Tool Kit/U-shaped Lock/Document Bag

CBR1000RR/RA

A tool kit, and document bag are located under the rear seat. There is also space to store a U-shaped lock.

CBR1000S

A tool kit, and document bag are located under the single seat cowl. There is also space to store a U-shaped lock.

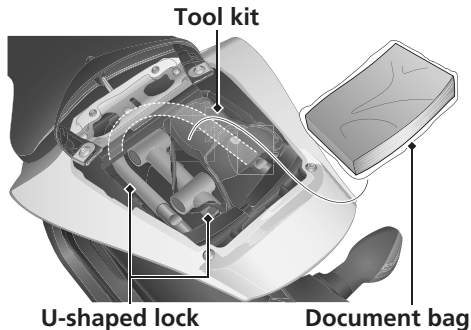

- ▶ The U-shaped lock is held in place above the rear fender.
- ▶ Some U-shaped locks may not fit in the compartment due to their size or design.

CBR1000RR/RA

▶ **Removing the Rear Seat** (P71)

CBR1000S

▶ **Removing the Single Seat Cowl** (P72)